

RSS-233 10K *Truck*

Self-Steering Auxiliary Axle Suspension

Lightweight Without Sacrificing Durability

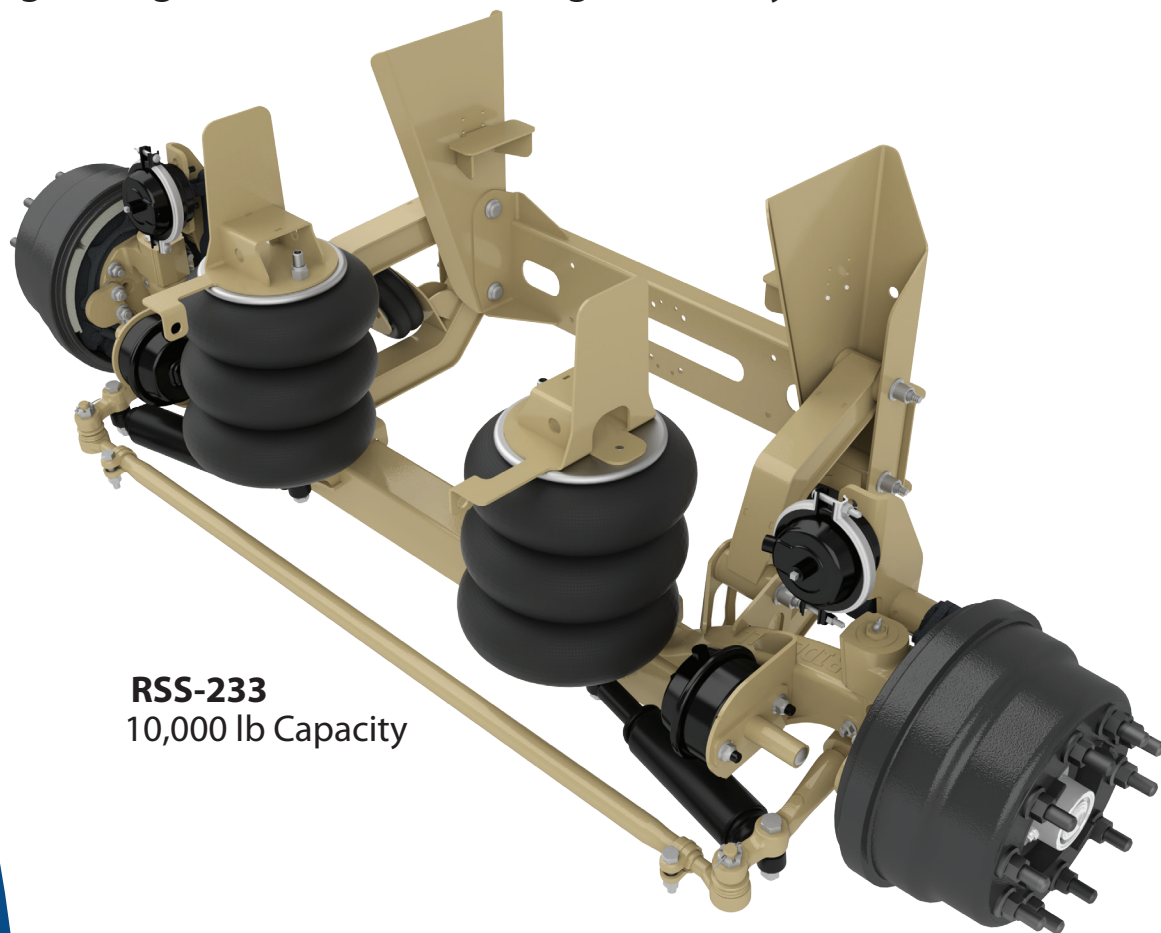

RSS-233
10,000 lb Capacity

13" total travel, maximum of 10" lift

Compact mounting envelope

Assembled with Huck® fasteners for reduced maintenance

Pre-plumbed air tank available

Lightweight wheel end option

5 year limited warranty



RSS-233 10K_{Truck}

Self-Steering Auxiliary Axle Suspension

Features

Industry Standard Tie Rod

- Traditional tie rod tube keeps wheel ends in alignment, extending tire life.

Forged one-piece steer knuckles

- Industry standard wheel end parts for simple replacement.

Wheel Ends

- 8-stud hub to accommodate 19.5" wheel and tire.

Fully Cast Axle Ends

- Durable Design adds strength to the critical axle transition area.

Optional Steer locks

- Unique design positively locks both wheel ends in the straight position at any wheel angle position.

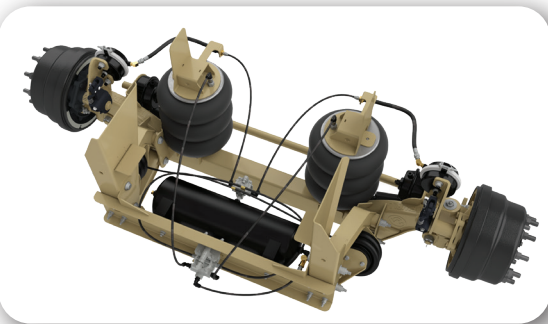

Optional Pre-plumbed Air Tank

Simplifies and decreases installation time.
Complies with RMVSS121 Brake Requirements

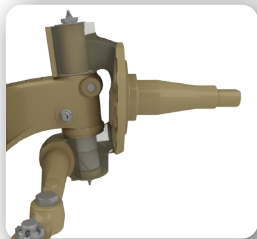

Dual Draw Key Kingpin

Design fully captures the kingpin within the axle end for longer service life and less down time.



Huck Bolts®

BOBTAIL® Huck Bolts® provide superior joint integrity and 10x the fatigue strength over conventional bolts.

Additional Features:

- Suspension ships fully assembled
- 7" - 18" ride heights
- 31.2 degree wheel cut
- Offset control arms for improved lateral stability



RIDEWELL
SUSPENSIONS

P.O. Box 4586 ♦ Springfield, Missouri 65808
www.ridewellcorp.com ♦ 800.641.4122 ♦ Fax 417.833.4560